

Ø50 TESTA TONDA / ROUND HEAD

Ø50 - DA VINCI SM - ST / VOLTA SM - PS - PP - PP2 - K7 / MARCONI ST - PS - K7

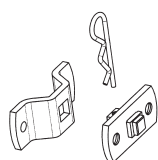
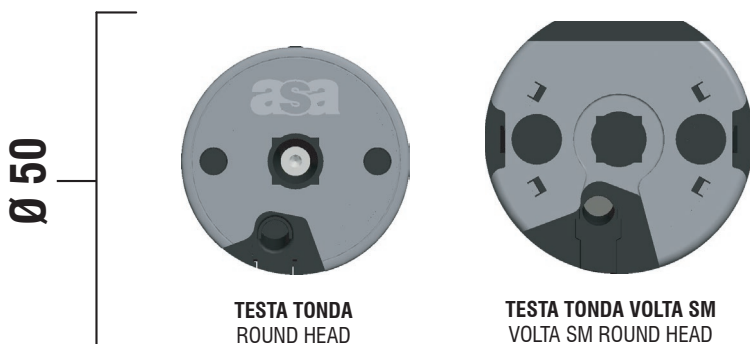

2204001

Staffa con perno quadrato completa di culla, interasse 48 mm e fori filettati
Bracket with square pin threaded holes with center-to-center distance 48 mm

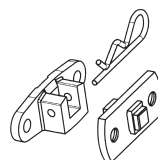

2204032

Staffa con perno quadrato con culla per innesto del perno "dall'alto"
(solo per motori max 30 Nm)
Bracket with "open" housing for the square pin, clutch the pin from "above" (only for motors max 30 Nm)

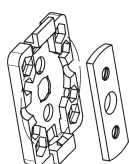

2204003

Staffa ad innesto "rapido", ridottissime dimensioni di ingombro e facile applicazione (solo per motori max 35 Nm)
Fast connection bracket minimum overall dimensions (only for motors max 35 Nm)

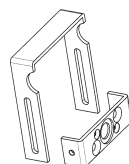

2204042

Staffa per mini cassonetti
Lunghezza 137 mm
Bracket for mini boxes
Length 137 mm

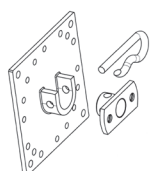

2204011

Staffa 100x100 con sella per perno rotondo a due posizioni
100x100 bracket with two positions round pin

NO VOLTA SM

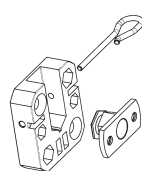

2204045

Staffa in zama con perno esagonale. L'inserimento del perno avviene "dall'alto"
Metal bracket with hexagonal pin clutch the pin from "above"

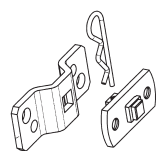

2204014

Staffa con perno quadrato completa di culla interasse 48/60 mm
Bracket with square pin center-to-center distance 48/60 mm

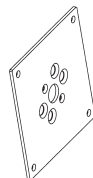

2204088

Staffa 100 x 100
100 x 100 bracket plate

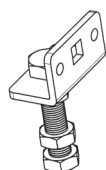

2204017

Staffa con perno Ø 10 per innesto diretto su murature già esistenti ideale nelle ristrutturazioni
Bracket Ø 10 threading pin for the direct clutch ideal for the existing clamp

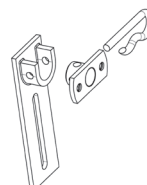

2204100

Staffa regolabile verticalmente con perno rotondo a due posizioni
Adjustable bracket with two positions round pin

NO VOLTA SM

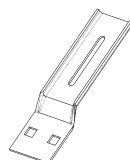

2204022

Staffa per supporti tipo "Torino" (aggiungere il perno quadrato per motori)
Bracket for support type "Torino" (match with square pin for motors)

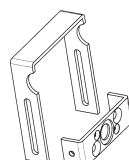

2204107

Staffa per mini cassonetti
Lunghezza 90 mm
Bracket for mini boxes
Length 90 mm

Ø50 TESTA TONDA / ROUND HEAD

Ø50 - DA VINCI SM - ST / VOLTA SM - PS - PP - PP2 - K7 / MARCONI ST - PS - K7

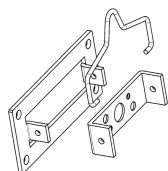
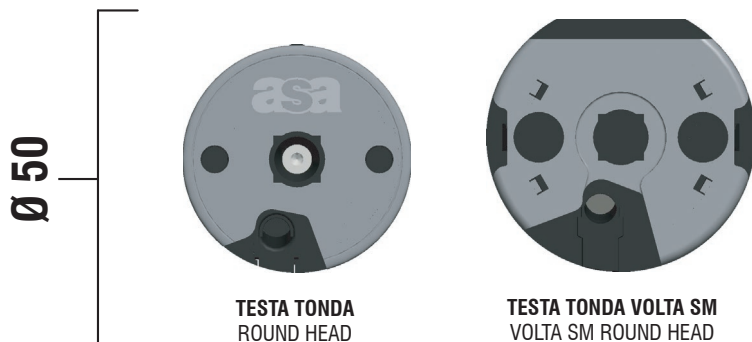

2204109



Staffa minimo ingombro
Minimum overall
dimensions bracket

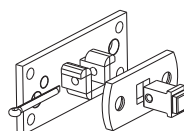

2204202



Staffa con culla per perno quadrato.
Interasse 48/60 mm
Bracket with two positions square pin
center-to-center distance 48/60 mm

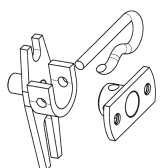

2204112



Staffa autocentrante per tende
completa di sella e perno
rotondo a due posizioni
Bracket for awnings with two positions
round pin

NO VOLTA SM

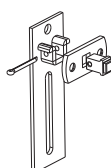

2204206



Staffa regolabile verticalmente
con perno quadrato a due posizioni
Adjustable bracket with two
positions square pin

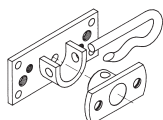

2204145



Staffa con perno rotondo
a due posizioni
Bracket with two positions round pin
and housing

NO VOLTA SM

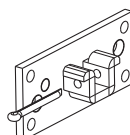

2204353



Staffa con culla per perno quadrato.
Interasse 48/60 mm
Bracket with two positions square pin
center-to-center distance 48/60 mm

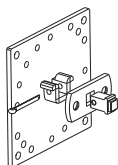

2204198



Staffa 100x100 per perno quadrato
100 x 100 bracket with two
positions square pin

Ø50 TESTA TONDA CON PERNO QUADRO INTEGRATO / ROUND HEAD WITH INTEGRATED SQUARE PIN

Ø50 - DA VINCI SM - ST / VOLTA SM - PS - PP - PP2 - K7 / MARCONI ST - PS - K7

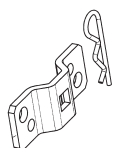

2204329



Staffa completa di culla.
Interasse 48/60 mm
Bracket with center-to-center distance 48/60 mm

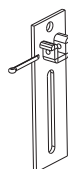

2204349



Staffa regolabile verticalmente a due posizioni
Adjustable bracket with two positions

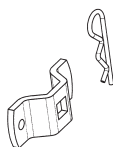

2204346



Staffa completa di culla, interasse 48 mm e fori filettati
Bracket with center-to-center distance 48 mm

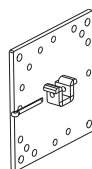

2204351



Staffa 100x100
100 x 100 bracket

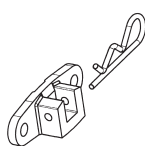

2204348



Staffa con culla per innesto del perno "dall'alto" (solo per motori max 30 Nm)
Bracket with "open" housing for the square pin (only for motors max 30 Nm)

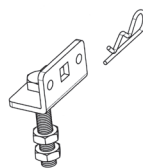

2204355



Staffa con perno Ø 10 per innesto diretto e copiglia (solo per motori con max 20 Nm)
Bracket with Ø 10 "click" square pin and splint pin for the direct clutch (only for motors max 20 Nm)

NO VOLTA SM

Ø50 INTERFACCIA TESTA A STELLA / STAR HEAD INTERFACE

Ø50 - DA VINCI SM - ST / VOLTA - SM - PS - PP2 - PP - K7 / MARCONI ST - PS - K7

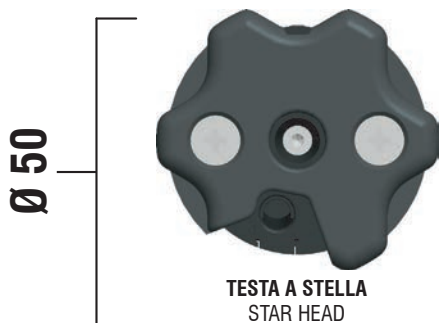

2204331

Interfaccia a stella per motori meccanici compatibile con le staffe clippabili Somfy
Star head interface for mechanical motors compatible with Somfy clipable brackets

DA VINCI 50



2204334

Interfaccia a stella per motori elettronici compatibile con le staffe clippabili Somfy
Star head interface for electronic motors compatible with Somfy clipable brackets

VOLTA 50
MARCONI 50



2204387

Interfaccia a stella specifica per motori elettronici filari VOLTA SM compatibile con le staffe clippabili Somfy
Star head interface specific for electronic wired motors VOLTA SM compatible with Somfy clipable brackets

VOLTA 50 SM



2204327

Staffa clippabile universale plastica (per motori max 30 Nm)
Clipable bracket universal plastic (motors max 30 Nm)

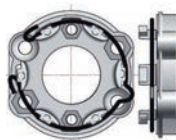

2204286

Staffa clippabile universale zama
Clipable bracket universal zama

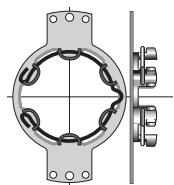

2204325

Staffa clippabile deprat
Clipable bracket deprat